

LINE CARD

Cable to Cable Connections



PT Connection Type

Cable Size		Mold Part No.	Weld Metal	
Run	Tap		UltraShot	NUWTUBE
29	29	PT-2929B	US115	NUWTUBE115
	28	PT-2928B	US150	NUWTUBE150
28	29	PT-2829B	US150	NUWTUBE150
	28	PT-2828B	US200	NUWTUBE200
#2	29	PT-229B	US90	NUWTUBE90
1/0	29	PT-1/029B	US90	NUWTUBE90
	28	PT-1/028B	US115	NUWTUBE115
2/0	29	PT-2/029B	US115	NUWTUBE115
	28	PT-2/028B	US150	NUWTUBE150
3/0	29	PT-3/029B	US150	NUWTUBE150
	28	PT-3/028B	US150	NUWTUBE150
4/0	29	PT-4/029B	US150	NUWTUBE150
	28	PT-4/028B	US150	NUWTUBE150



RT Connection Type

Cable Size		Mold Part No.	Weld Metal	
Run	Tap		UltraShot	NUWTUBE
29	29	RT-2929B	US115	NUWTUBE115
	28	RT-2928B	US115	NUWTUBE115
28	29	RT-2829B	US115	NUWTUBE115
	28	RT-2828B	US115	NUWTUBE115
2/0	29	RT-2/029B	US115	NUWTUBE115
	28	RT-2/028B	US115	NUWTUBE115
4/0	29	RT-4/029B	US90	NUWTUBE90
	28	RT-4/028B	US115	NUWTUBE115



PB Connection Type

Cable Size		Mold Part No.	Weld Metal	
Run	Tap		UltraShot	NUWTUBE
29	28	PB-2929B	US115	NUWTUBE115
28	28	PB-2828B	US150	NUWTUBE150

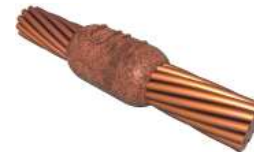

BS Connection Type

Cable Size		Mold Part No.	Weld Metal	
Run	Tap		UltraShot	NUWTUBE
29	29	BS-29B	US65	NUWTUBE65
32	32	BS-32B	US65	NUWTUBE65
28	28	BS-28B	US90	NUWTUBE90
4/0	29	BS-4/029B	US90	NUWTUBE90
	28	BS-4/028B	US90	NUWTUBE90

Cable to Ground Rod Connections



GD Connection Type

Ground Rod Size*	Cable Size	Mold Part No.	Weld Metal	
			UltraShot	NUWTUBE
5/8"	29	GD-5829B	US115	NUWTUBE115
	28	GD-5828B	US115	NUWTUBE115
3/4"	29	GD-3429B	US115	NUWTUBE115
	28	GD-3428B	US115	NUWTUBE115

*Copper-Clad ground rod nominal dimensions.



GO Connection Type

Ground Rod Size*	Cable Size	Mold Part No.	Weld Metal	
			UltraShot	NUWTUBE
5/8"	29	GO-5829B	US150	NUWTUBE150
	28	GO-5828B	US150	NUWTUBE150
3/4"	29	GO-3429B	US150	NUWTUBE150
	28	GO-3428B	US150	NUWTUBE150

*Copper-Clad ground rod nominal dimensions.

Cable to Steel Surface Connections



VA Connection Type

Cable Size	Mold Part No.	Weld Metal	
		UltraShot	NUWTUBE
29	VA-29B	US90	NUWTUBE90
32	VA-32B	US90	NUWTUBE90
28	VA-28B	US115	NUWTUBE115
4/0	VA-4/0B	US115	NUWTUBE115



VD Connection Type

Cable Size	Mold Part No.	Weld Metal	
		UltraShot	NUWTUBE
29	VD-29B	US115	NUWTUBE115
32	VD-32B	US115	NUWTUBE115
28	VD-28B	US115	NUWTUBE115
4/0	VD-4/0B	US150	NUWTUBE150

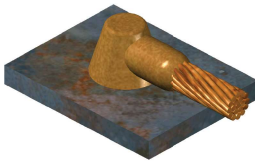

HB Connection Type

Cable Size	Mold Part No.	Weld Metal	
		UltraShot	NUWTUBE
29	HB-29B	US115	NUWTUBE115
32	HB-32B	US115	NUWTUBE115
28	HB-28B	US115	NUWTUBE115
4/0	HB-4/0B	US115	NUWTUBE115

*For connections to pipe, please contact factory.

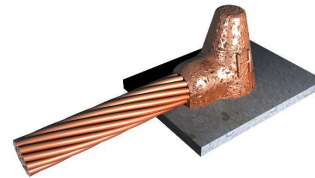

HD Connection Type

Cable Size	Mold Part No.	Weld Metal	
		UltraShot	NUWTUBE
29	HD-29B	US115	NUWTUBE115
32	HD-32B	US115	NUWTUBE115
28	HD-28B	US115	NUWTUBE115
4/0	HD-4/0B	US115	NUWTUBE115

*For connections to pipe, please contact factory.



VA Pipe Connection Type

Cable Size	Nominal Pipe Size	Mold Part No.	Weld Metal	
			UltraShot	NUWTUBE
29	1-1/4" to 4" 4" to 6"	VD-29V1.25X4B	US115	NUWTUBE115
		VD-29V4X6B	US115	NUWTUBE115
28	2" to 4" 4" to 12"	VD-28V2X4B	US115	NUWTUBE115
		VD-28V4X12B	US115	NUWTUBE115



These Ultraweld connections are listed to UL 467 and rated for direct burial. This line card represents the most frequent connection requirements in lightning protection applications. For a full listing of Harger's exothermic offering, please visit Harger.com or access the Harger Master Equipment Catalog. Instructional videos, installation sheets, and other exothermic connection support materials are available by scanning the QR code printed on all Harger mold tags.



Scan QR Code for Video Instructions



Ultraweld® - UltraShot® & NUWTube®

UltraShot® Features

- Patented copper drop-in cartridge consumed during the reaction process.
- The electronic ignition system fires instantly and uses a Milwaukee® M18™ REDLITHIUM™ 18 volt battery with a built-in fuel gauge.
- Audible Ignition Alert.
- Six-foot controller cord allows for flexibility in tight spaces as well as maintaining a safe distance from the reaction.



UltraShot® Benefits

- Cartridge is consumed leaving less waste such as plastic or metal containers on the job site.
- Long lasting **Ultra**-reliable ignition process allows for little to no downtime on the job site.
- UltraShot can be easily converted to the LOsmoke™ System.

UltraShot® (Drop-In) Weld Metal

Size	Qty. Per Carton	Size	Qty. Per Carton
US25	20	US200	10
US32	20	US250	10
US45	20	US300	10
US65	20	US400	5
US90	10	US500	5
US115	10	US600	5
US150	10	US750	5

NUWTube®

- Uses the traditional method of ignition with starting powder.
- Innovative dual chamber design keeps weld metal and starting powder separate until point of use.
- Reduces material and labor costs by eliminating migrating starting powder issues.
- Less starting powder is needed, thereby reducing the amount of flash during the ignition process.

NUWTube® (Powder) Weld Metal

Size	Qty. Per Carton	Size	Qty. Per Carton
NUWTUBE15	20	NUWTUBE90	10
NUWTUBE25	20	NUWTUBE115	10
NUWTUBE32	20	NUWTUBE150	10
NUWTUBE45	20	NUWTUBE200	10
NUWTUBE65	20	NUWTUBE250	10

Handle Clamps Required:

MH1 for **B, K, P & Q** Price Key Molds
 MH2 for **C** Price Key Molds
 MH3 for **GS** Style **R** Price Key Molds
 MH6 for **I** Price Key Molds

L & M Price Key Molds SOLD WITH HANDLES
A Price Key Molds SOLD WITH FRAME



Tools & Accessories



#MH1, #MH2
Mold Handle



#MSKIT
Magnetic Support Kit



#MLDSTBLZR
Mold Stabilizer Kit



#DRONE
Compact UltraShot
Controller
(Pat. # US 9,562,751)



#MIL1820BAT
Drone Battery



#MH6, #MH7
Mold Handle



#UMHDKIT
Hold Down Kit



#MCBRSH1
Mold Cleaning
Brush (large)



#DRONECASE
Drone Controller
Storage Case



#CSKIT
Chain Support Kit



#CCBRSH2
Cable Cleaning Brush



#CCBRSH1
Cable Cleaning
Brush



#USBOXKIT
Toolbox with UltraShot Trays
(UltraShot Sold Separately)



#UWMOLDBOX
UltraWeld® Mold
Storage

Established in 1960, Harger manufactures high quality products and combines them with exceptional customer service and technical expertise. Harger has the resources and partnerships to support your needs from planning stages to project completion.



Approximately 35 miles from Chicago, the corporate office and 65,000 square foot facility is located in Grayslake, Illinois.



Another 95,000 square foot manufacturing plant, approximately 110 miles south of Raleigh, is located in Fairmont, North Carolina.



Harger Lightning & Grounding
301 Ziegler Drive • Grayslake, IL 60030
Phone: 800-842-7437 • 847-548-8700
www.harger.com • sales@harger.com



UWLCLP-3.23