

COPPER RACK GROUND BAR

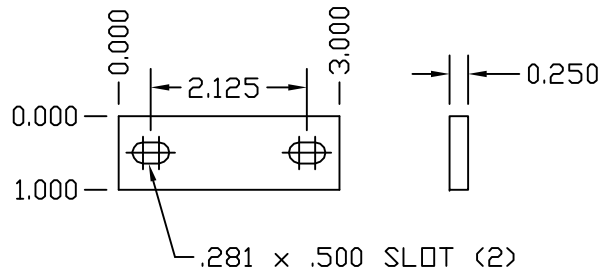

SPLICE PLATE

- KIT INCLUDES:
- (2)-12-24 X 3/4" CU. MACHINE SCREW
 - (2)-#12 CU. FLAT WASHER
 - (8)-#6-32 X 1/4" CU. MACHINE SCREW
 - (8)-#6 RING TERMINAL

HWKITPTS (1)

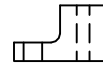

11/16WINS (2)



SMS0126SHWZ (2)

TINNED COPPER RACK
GROUND BAR KIT

EST WT 3#

APPROVED

AS DRAWN: _____
 AS NOTED: _____
 DATE: _____

THIS DOCUMENT AND THE CONTENTS THEREOF IS THE PROPERTY OF HARGER INC., AND IS FURNISHED TO YOU FOR INFORMATION ONLY. THE INFORMATION CONTAINED HEREIN IS CONFIDENTIAL AND OF A PROPRIETARY NATURE AND MUST NOT BE DISCLOSED TO THIRD PARTIES WITHOUT THE EXPRESS WRITTEN APPROVAL OF HARGER INC.

LET	REVISION	DATE	BY

TOLERANCES UNLESS NOTED:
 FRACTIONAL +/- 1/16
 DECIMAL +/- .030
 BREAK SHARP EDGES

3RD ANGLE PROJECTION

PART NO. TRGBHKIT14119.25
 RACK GROUND BAR KIT

DRAWN BY:
LAL
 CHECKED BY:
-
 DATE:
071516

HARGER
 301 ZIEGLER DRIVE
 GRAYSLAKE, IL 60030
 (847) 548-8700

REVISION:
-
 SCALE:
3/8
 SHEET:
1 OF 1