

GROUND BAR

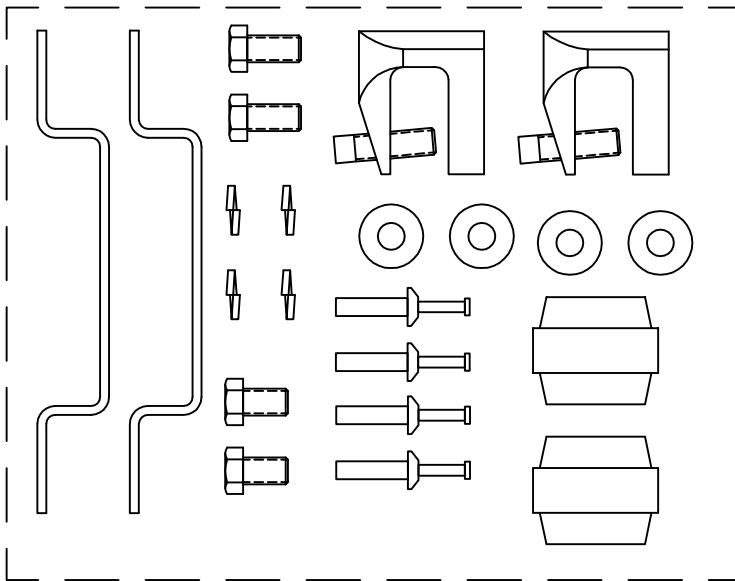

EST WT 9#

THIS DOCUMENT AND THE CONTENTS THEREOF IS THE PROPERTY OF HARGER INC., AND IS FURNISHED TO YOU FOR INFORMATION ONLY. THE INFORMATION CONTAINED HEREIN IS CONFIDENTIAL AND OF A PROPRIETARY NATURE AND MUST NOT BE DISCLOSED TO THIRD PARTIES WITHOUT THE EXPRESS WRITTEN APPROVAL OF HARGER INC.

LET	REVISION	DATE	BY
TOLERANCES UNLESS NOTED:			
FRACTIONAL	+/-	1/64	
.00	+/-	.010	
.000	+/-	.005	

PART NO. TGBU14420M

DRAWN BY:  
LAL  
CHECKED BY:  
DATE:  
050905

**HARGER**<sup>™</sup>  
301 ZIEGLER DRIVE  
GRAYSLAKE, IL 60030  
(847) 548-8700

REVISION:  
-  
SCALE:  
3/8  
SHEET:  
-