

HARGER[®]



Surge Protective Devices HSA Series



Features

- 100kA I_{max}
- UL 1449 ed. 5 listed
- NEMA 4X Enclosure
- 20kA I-nominal

Product Specifications

Maximum Surge Current Rating, I _{max}	100kA per phase
UL 1449 I-nominal rating, I _n	20kA
UL 1449 Short Circuit Current Rating, SCCR	200kA
UL Mounting Location	Type 1 / 2
Response Time	<1 ns
Modes of Protection	L-N, L-G, N-G, L-L
Visual Status Indication	Green LED (2 per mode)
Audible Status Indication	Alarm
Humidity Range	0-95% non-condensing
Operating Frequency	47-63Hz
Operating Temperature (F)	-13 to 185
Wiring Leads	24" - #12 AWG
Typical Breaker	30 Amp

Product Ordering Information						
Part No.	System Voltage	MCOV	VPR Data			
			L-N	L-G	N-G	L-L
HSA120SP	120/240 Split	175	700	700	700	1200
HSA1203Y	120/208 3Y	150	600	600	600	1000
HSA2773Y	277/480 3Y	320	1200	1200	1200	2000
Mounting Options						
HSFM	Flush mount kit for drywall					
HSBM	Bracket mount kit					

Wiring Configurations

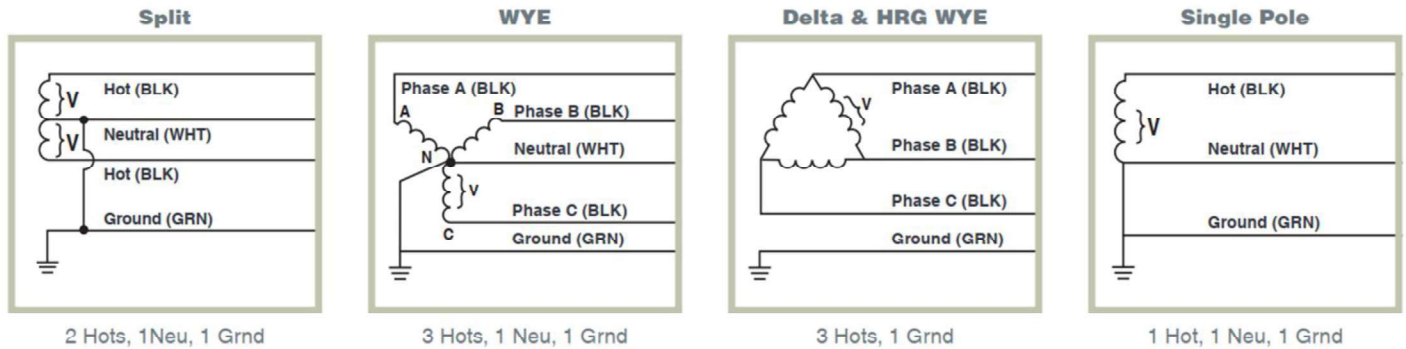

Product Dimensions

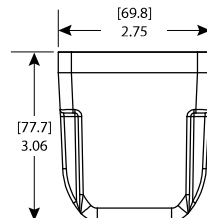
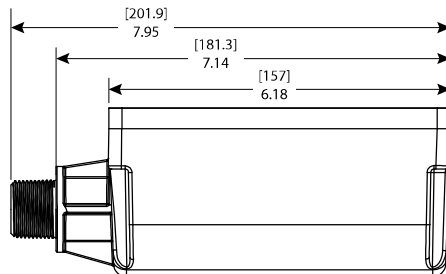
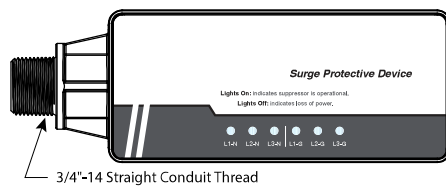

Enclosure Specifications	
Enclosure	7.95" x 3.06" x 2.75"
Weight	1.38 lbs.
Enclosure Material	Polycarbonate, NEMA 4X
Installation Location	Indoor / Outdoor